

CONSTRUCTION SEQUENCE

- CALL FOR A PRECONSTRUCTION MEETING WITH THE CITY INSPECTOR PRIOR TO STARTING ANY WORK.
- MARK CLEARING LIMITS AS SHOWN WITH ORANGE CONSTRUCTION FENCING.
- INSTALL TEMPORARY ROCKED CONSTRUCTION ENTRANCE.
- CLEAR AND GRUB SITE, INSTALL FILTER FENCE AND TEMPORARY INTERCEPTOR DITCHES AS CONSTRUCTION ACTIVITIES PROGRESS. ADDITIONAL FILTER FENCE MAY BE REQUIRED AROUND THE PERIMETER TO PREVENT SILT LADEN WATER FROM LEAVING THE SITE.
- CLEAR AND INSTALL TEMPORARY SEDIMENT PONDS.
- ROUGH GRADE ROADWAYS AND CONSISTENT WITH THE SEQUENCING OF THE GRADING AS SHOWN ON SHEET C3. PLACE THE GEO-FABRIC AT ELEVATIONS NOT TO EXCEED 15.00.
- FOLLOW THE STEP BY STEP PROCEDURE CALLED OUT ON SHEET C3 REGARDING THE FABRIC PLACEMENT, BE ESPECIALLY CAREFUL IN THE PLACEMENT OF THE CLAY LINERS FOR THE BIO-FILTRATION SWALES.
- INSTALL UTILITIES AND PERMANENT STORM DRAINAGE ELEMENTS.
- COMPLETE THE ROUGH GRADING OF ALL AREAS, BEING CAREFULLY TO COMPACT FILL AREAS PER THE APPROVED CLEARING AND GRADING PERMIT.
- FINE GRADE AND PAVE THE ROADWAYS AND THE PARKING AREAS.
- HYDROSEED AND MULCH ALL EXPOSED AREAS.
- REMOVE TEMPORARY EROSION CONTROL FACILITIES ONLY AFTER ENTIRE SITE IS STABILIZED, THE POTENTIAL FOR EROSION HAS PASSED, AND THE CITY HAS APPROVED.
- CLEAN ANY SILT WHICH HAS ACCUMULATED IN THE PERMANENT STORM DRAINAGE SYSTEM, THE BIO-FILTRATION SWALES ON SITE, AND THE BIO-FILTRATION SWALES ALONG PROPERTIES NORTH LINE.

GENERAL NOTES

- ALL WORK AND MATERIALS SHALL BE IN ACCORDANCE WITH SKAGIT COUNTY ENGINEERING DESIGN AND DEVELOPMENT STANDARDS, WASHINGTON STATE DEPARTMENT OF TRANSPORTATION/AMERICAN PUBLIC WORKS ASSOCIATION 1998 STANDARD SPECIFICATIONS FOR ROAD, BRIDGE, AND MUNICIPAL CONSTRUCTION, THE CITY OF ANACORTES STANDARD PLANS AND SPECIFICATIONS, AND THE 1989 W.S.D.O.T. HYDRAULICS MANUAL.
- ALL WORK PERTAINING TO THIS PROJECT SHALL BE SUBJECT TO INSPECTION BY THE CITY ENGINEER OR HIS DESIGNATED REPRESENTATIVE. PRIOR TO ANY SITE WORK, THE CONTRACTOR SHALL CONTACT THE CITY PUBLIC WORKS DEPARTMENT AT (360) 293-1919 TO SCHEDULE A PRECONSTRUCTION CONFERENCE.

- PRIOR TO ANY SITE DISTURBING ACTIVITY INCLUDING CLEARING, LOGGING OR GRADING, THE SITE CLEARING LIMITS AS SHOWN ON THESE PLANS SHALL BE LOCATED AND FIELD IDENTIFIED BY THE PROJECT SURVEYOR. THE PROJECT SURVEYOR'S NAME AND TELEPHONE NUMBER ARE LEONARD, BOUDINOT & SKODJE, INC. (360) 336-5751.
- THE OWNER IS RESPONSIBLE FOR ENSURING WATER QUALITY DURING CONSTRUCTION AND SHALL RETAIN A REGISTERED CIVIL ENGINEER TO MONITOR WATER QUALITY. THE ENGINEER SHALL RECOMMEND CHANGES OR MODIFICATIONS TO THE APPROVED TESC PLAN AS REQUIRED BY SITE CONDITIONS ENCOUNTERED. PRIOR TO SCHEDULING THE REQUIRED PRE-CONSTRUCTION MEETING WITH THE CITY, THE OWNER SHALL PROVIDE THE CITY WITH DOCUMENTATION THAT AN ENGINEER HAS BEEN RETAINED FOR THE PURPOSE OF MONITORING WATER QUALITY DURING CONSTRUCTION.
- A COPY OF THESE APPROVED PLANS MUST BE ON THE JOB SITE WHENEVER CONSTRUCTION IS IN PROGRESS.
- ALL SITE WORK IMPROVEMENTS SHALL BE CONSTRUCTED IN ACCORDANCE WITH THESE APPROVED PLANS. ANY DEVIATION FROM THESE PLANS WILL REQUIRE PRIOR APPROVAL FROM THE OWNER, ENGINEER AND APPROPRIATE PUBLIC AGENCIES.
- ALL LOCATIONS OF EXISTING UTILITIES SHOWN HEREON HAVE BEEN ESTABLISHED BY FIELD SURVEY OR OBTAINED FROM AVAILABLE RECORDS AND SHOULD THEREFORE BE CONSIDERED APPROXIMATE ONLY AND NOT NECESSARILY COMPLETE. IT IS THE SOLE RESPONSIBILITY OF THE CONTRACTOR TO INDEPENDENTLY VERIFY THE ACCURACY OF ALL UTILITY LOCATIONS SHOWN AND TO FURTHER DISCOVER AND AVOID ANY OTHER UTILITIES NOT SHOWN HEREON WHICH MAY BE AFFECTED BY THE IMPLEMENTATION OF THIS PLAN. THE CONTRACTOR SHALL CONTACT THE UNDERGROUND UTILITIES LOCATION SERVICE (1-800-424-5555) AT LEAST 48 HOURS PRIOR TO CONSTRUCTION. THE OWNER OR HIS REPRESENTATIVE AND THE ENGINEER SHALL BE CONTACTED IMMEDIATELY IF CONFLICTS ARE FOUND.
- THE CONTRACTOR SHALL BE RESPONSIBLE FOR PROVIDING ADEQUATE SAFEGUARDS, SAFETY DEVICES, PROTECTIVE EQUIPMENT, FLAGGERS, AND ANY OTHER NEEDED ACTIONS TO PROTECT THE LIFE, HEALTH AND SAFETY OF THE PUBLIC, AND TO PROTECT PROPERTY IN CONNECTION WITH THE PERFORMANCE OF WORK COVERED BY THE CONTRACT. ANY WORK WITHIN THE TRAVELED RIGHT-OF-WAY THAT MAY INTERRUPT NORMAL TRAFFIC FLOW SHALL REQUIRE AT LEAST ONE FLAGGER FOR EACH LANE OF TRAFFIC AFFECTED. ALL SECTIONS OF THE WSDOT STANDARD SPECIFICATIONS 1-07.23 - TRAFFIC CONTROL SHALL APPLY.
- THE CONTRACTOR SHALL KEEP OFF-SITE STREETS CLEAN AT ALL TIMES BY SWEEPING. WASHING OF THESE STREETS WILL NOT BE ALLOWED WITHOUT PRIOR CITY OF ANACORTES APPROVAL.
- THE CONTRACTOR SHALL VERIFY ALL FIELD CONDITIONS PRIOR TO INITIATING WORK. THE CONTRACTOR/OWNER SHALL NOTIFY SCHEMMER ENGINEERING INC. AND THE CITY ENGINEER WHEN CONFLICTS OCCUR BETWEEN THE PLANS AND FIELD CONDITIONS. CONFLICTS SHALL BE RESOLVED PRIOR TO PROCEEDING WITH CONSTRUCTION.
- UNLESS OTHERWISE NOTED, THE CONTRACTOR SHALL BE RESPONSIBLE FOR COORDINATING ANY UTILITY RELOCATIONS.
- SURVEY MONUMENTS SHALL BE INSTALLED IN ACCORDANCE WITH CITY OF ANACORTES STANDARDS PER THEIR TYPICAL MONUMENT DETAIL.

TESC NOTES:

- APPROVAL OF THIS TEMPORARY EROSION AND SEDIMENTATION CONTROL (TESC) PLAN DOES NOT CONSTITUTE AN APPROVAL OF PERMANENT ROAD OR DRAINAGE DESIGN.
- THE IMPLEMENTATION OF THESE TESC PLANS AND THE CONSTRUCTION, MAINTENANCE, REPLACEMENT AND UPGRADING OF THESE TESC FACILITIES IS THE RESPONSIBILITY OF THE APPLICANT/TESC SUPERVISOR UNTIL ALL CONSTRUCTION IS APPROVED.
- THE BOUNDARIES OF THE CLEARING LIMITS SHOWN ON THIS PLAN SHALL BE CLEARLY FLAGGED BY A CONTINUOUS LENGTH OF ORANGE CONSTRUCTION FENCING PRIOR TO CONSTRUCTION. DURING THE CONSTRUCTION PERIOD NO DISTURBANCE BEYOND THE CLEARING LIMITS SHALL BE PERMITTED. THE CLEARING LIMITS SHALL BE MAINTAINED BY THE APPLICANT/TESC SUPERVISOR FOR THE DURATION OF CONSTRUCTION.
- THE TESC FACILITIES SHOWN ON THIS PLAN MUST BE CONSTRUCTED PRIOR OR IN CONJUNCTION WITH ALL CLEARING AND GRADING SO AS TO ENSURE THAT THE TRANSPORT OF SEDIMENT TO SURFACE WATERS, DRAINAGE SYSTEMS, AND ADJACENT PROPERTIES IS MINIMIZED.
- THE TESC FACILITIES SHOWN ON THIS PLAN ARE THE MINIMUM REQUIREMENTS FOR ANTICIPATED SITE CONDITIONS. DURING THE CONSTRUCTION PERIOD, THESE TESC FACILITIES SHALL BE UPGRADED AS NEEDED FOR UNEXPECTED STORM EVENTS AND MODIFIED TO ACCOUNT FOR CHANGING SITE CONDITIONS.
- THE TESC FACILITIES SHALL BE INSPECTED DAILY BY THE APPLICANT/TESC SUPERVISOR AND MAINTAINED TO ENSURE CONTINUED PROPER FUNCTIONING. WRITTEN RECORDS SHALL BE KEPT OF WEEKLY REVIEWS OF THE TESC FACILITIES DURING THE WET SEASON (OCT. 1 TO MARCH 31) AND OF MONTHLY REVIEWS DURING THE DRY SEASON (APRIL 1 TO SEPT. 30).
- ANY AREAS OF EXPOSED SOILS, INCLUDING ROADWAY EMBANKMENTS, THAT WILL NOT BE DISTURBED FOR TWO DAYS DURING THE WET SEASON OR SEVEN DAYS DURING THE DRY SEASON SHALL BE IMMEDIATELY STABILIZED WITH APPROVED TESC METHODS (SEEDING, MULCHING, PLASTIC COVERING, ETC.).
- ANY AREA NEEDING TESC MEASURES, NOT REQUIRING IMMEDIATE ATTENTION, SHALL BE ADDRESSED WITHIN FIFTEEN (15) DAYS.
- THE TESC FACILITIES ON INACTIVE SITES SHALL BE INSPECTED AND MAINTAINED A MINIMUM OF ONCE A MONTH OR WITHIN 48 HOURS OF A STORM EVENT.
- AT NO TIME SHALL MORE THAN ONE (1) FOOT OF SEDIMENT BE ALLOWED TO ACCUMULATE WITHIN A CATCH BASIN. ALL CATCH BASINS AND CONVEYANCE LINES SHALL BE CLEANED PRIOR TO PAVING. THE CLEANING OPERATION SHALL NOT FLUSH SEDIMENT-LADEN WATER INTO THE DOWNSTREAM SYSTEM.
- STABILIZED CONSTRUCTION ENTRANCES AND ROADS SHALL BE INSTALLED AT THE BEGINNING OF CONSTRUCTION AND MAINTAINED FOR THE DURATION OF THE PROJECT. ADDITIONAL MEASURES, SUCH AS WASH PADS, MAY BE REQUIRED TO ENSURE THAT ALL PAVED AREAS ARE KEPT CLEAN FOR THE DURATION OF THE PROJECT.
- ANY PERMANENT RETENTION/DETENTION FACILITY USED AS A TEMPORARY SETTLING BASIN SHALL BE MODIFIED WITH THE NECESSARY EROSION CONTROL MEASURES AND SHALL PROVIDE ADEQUATE STORAGE CAPACITY.
- SPECIAL INSPECTION FOR EXCAVATION, GRADING AND FILLING IS REQUIRED IN ACCORDANCE WITH 1991 UBC SEC 30 (A) 13.
- FINAL REPORT (AS BUILT DRAWINGS) SHALL BE SUBMITTED TO THE CITY OF ANACORTES UPON COMPLETION OF WORK IN ACCORDANCE WITH THE CITY OF ANACORTES AS-BUILT REQUIREMENTS.
- ALL GEOTECHNICAL INSPECTION NOTES SHALL BE PROVIDED TO THE CITY OF ANACORTES ON A WEEKLY BASIS FOR REVIEW BY THE CITY'S ENGINEER.

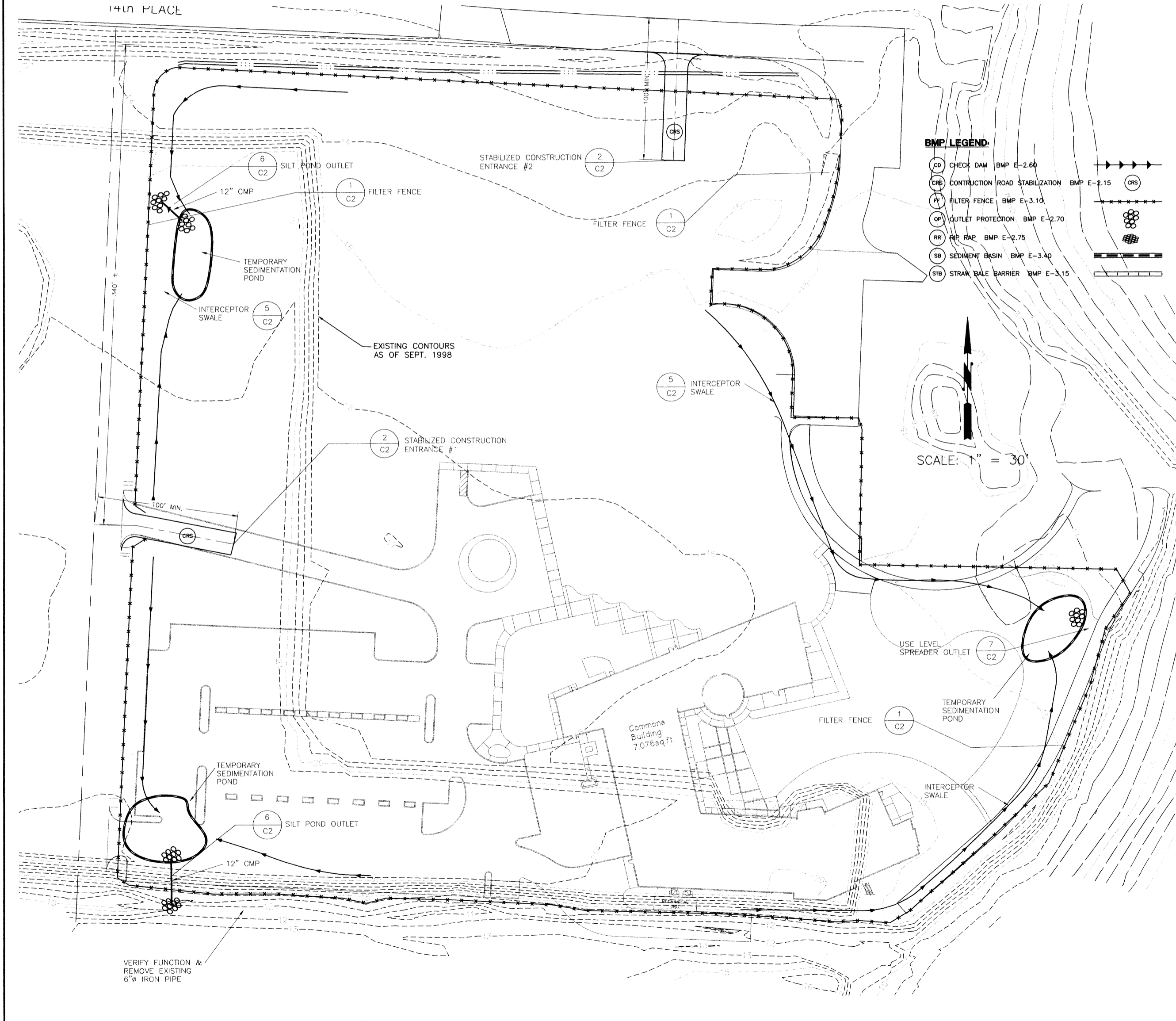

DESIGNED	JAS	7/6/98	REVISOR	PER CITY REVIEW
DRAWN	SBK	7/14/98	REVISOR	PER ARCHITECT REVIEW
CHECKED	JAS			
DATE	5/14/99			

SCHEMMER ENGINEERING INC.
 1004 COMMERCIAL AVENUE, SUITE 152
 ANACORTES, WA 98221-4183 (360) 293-1960

SUN SYSTEMS, INC.
CLEARING, GRADING & TESC PLAN

JOB NO. 98-02
 SHEET C1
 1 OF 11