

STEP #1

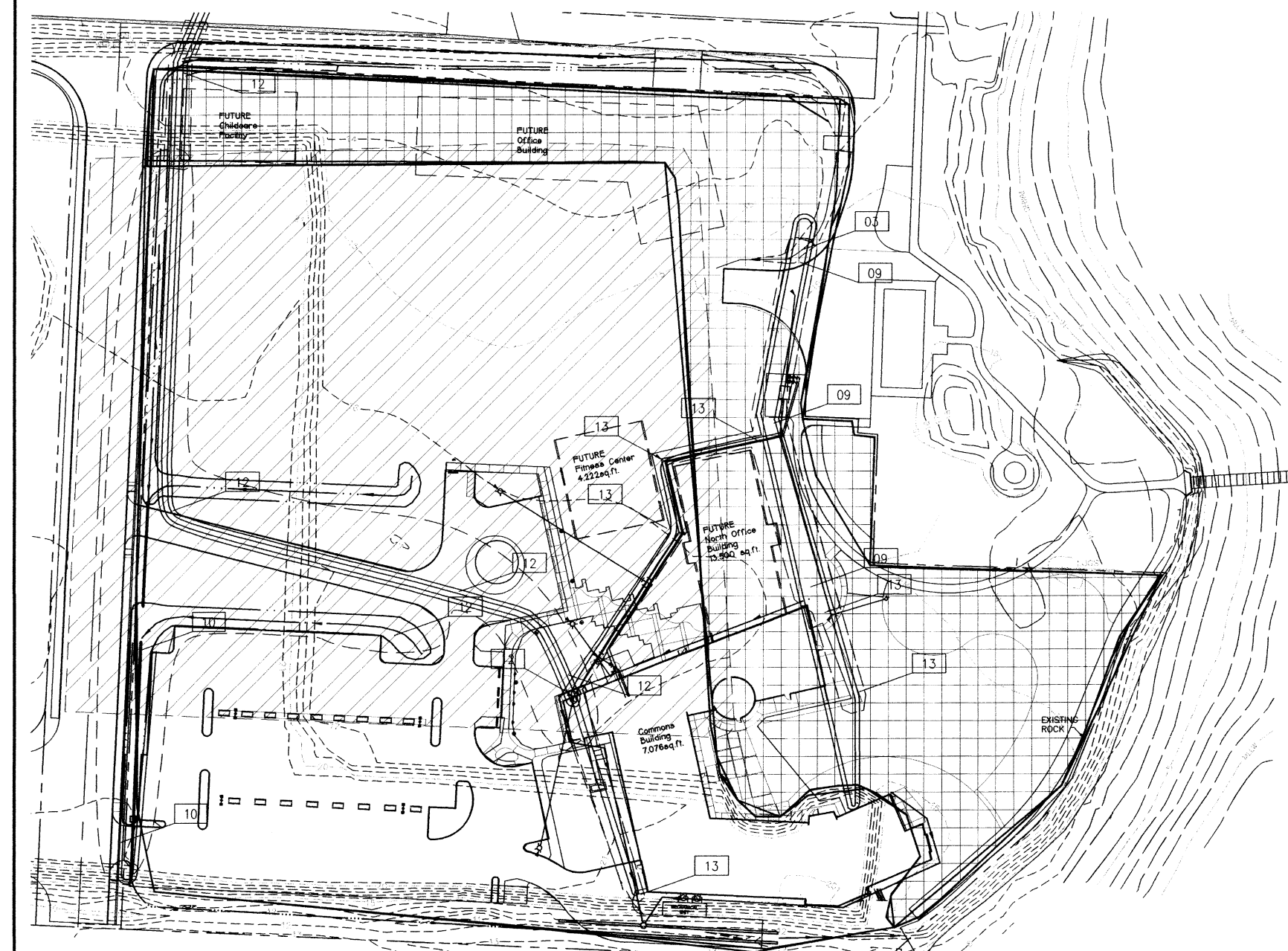

STEP #2

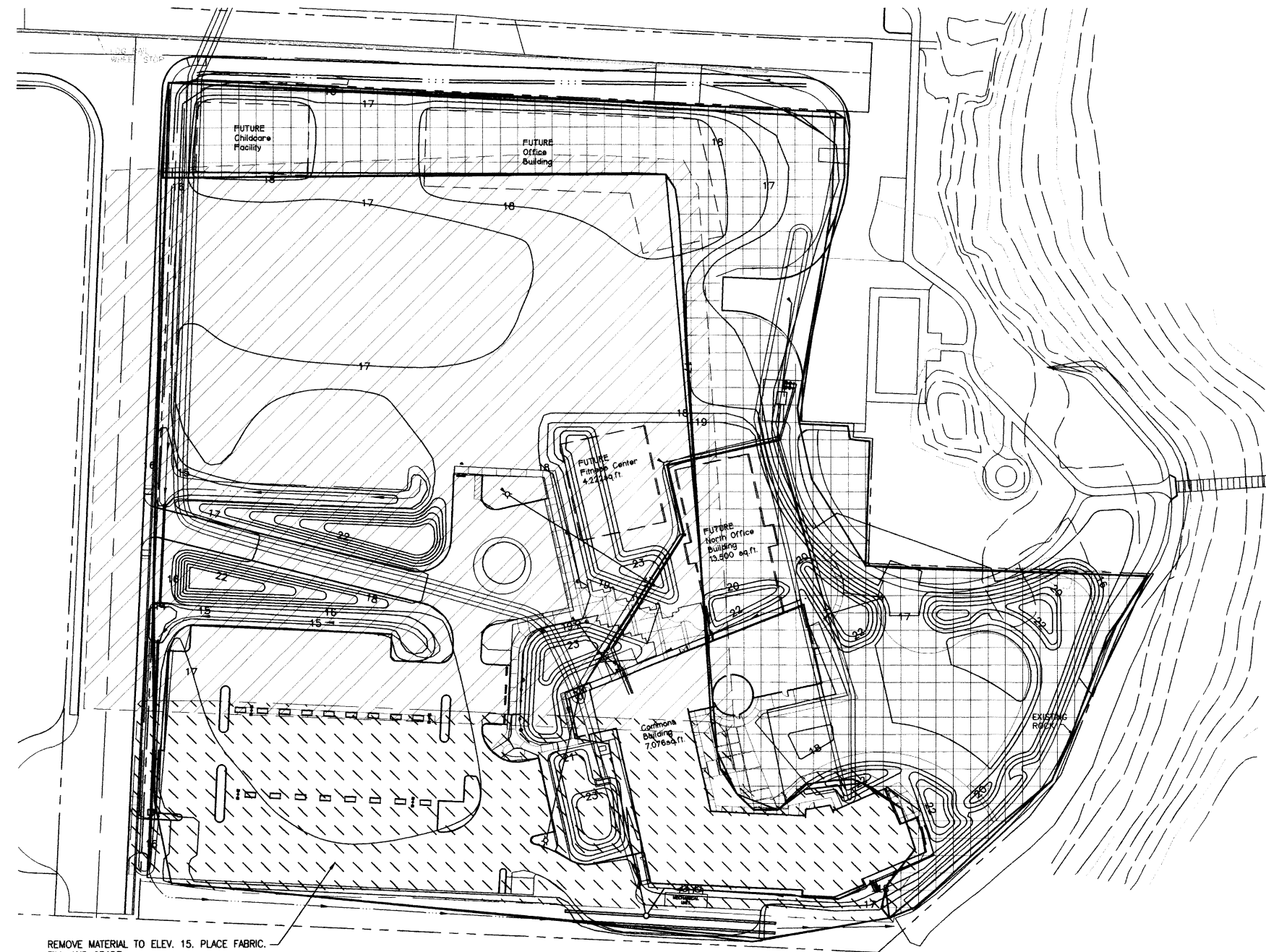

STEP #3

STEP # 1
 SHAPE AREA SUCH THAT SOIL ABOVE ELEVATION 15.0 IN AREA OF FABRIC #1 IS MOVED. NO ELEVATION TO REMAIN ABOVE ELEVATION 15.0
 PLACE FABRIC PER SPECIFICATIONS IN AREA #1.
 NOTE: EXISTING FABRIC OR FABRIC PLACED PER STEP #1 MAY BE RAISED AS LONG AS ELEVATION 15.0 IS NOT EXCEEDED.

STEP # 2
 AFTER FABRIC IS PLACED PER STEP #1, EXCAVATE CORRIDORS FOR UTILITIES, BIO-SWALE, AND STORM DRAINS AS SHOWN TO FINISH SUB-GRADE AND ELEVATIONS SHOWN. ALL EXCAVATION BELOW FABRIC (EXISTING FABRIC AND FABRIC #1) IS CONSIDERED UNSUITABLE. EITHER REMOVE FROM SITE OR PLACE ON SITE BELOW FABRIC AND BELOW ELEVATION 15.0.
 AFTER CORRIDORS ARE EXCAVATED TO SUB-GRADE ELEVATIONS SHOWN, PLACE FABRIC PER DETAILS ON SHEET C-6 TO OVERLAP EXISTING FABRIC 2 FEET EACH SIDE AND FILL TO ROUGH GRADE.
 EXCAVATION ABOVE EXISTING FILTER FABRIC MAY BE PLACED ABOVE ANY FABRIC ON SITE AND IS TO BE PLACED AND COMPACTED PER APPROVED SPECIFICATIONS FOR COMPACTION.

STEP # 3
 EXCAVATE AREA SHOWN PER STEP #3 TO ELEVATION 15.0, AND PLACE FABRIC.
 USE MATERIAL THAT IS EXCAVATED TO FILL ON-SITE AREAS THAT LIE ABOVE FABRIC AND COMPACT TO SPECIFIED DENSITIES.

FINAL STEPS TO COMPLETE ROUGH GRADING
 IMPORT BORROW AS REQUIRED FROM OFFSITE AREA AND COMPACT AS SPECIFIED.
 ESTABLISH SUBGRADES THROUGHOUT PLANTING, SEEDING AND LANDSCAPE BERM AREAS AS SPECIFIED IN SECTION 02920, SOIL PREPARATION.

LEGEND

	EXISTING FILTER FABRIC
	PROPOSED FILTER FABRIC #1
	PROPOSED FILTER FABRIC #2
	ELEV. AT BASE OF EXCAVATION

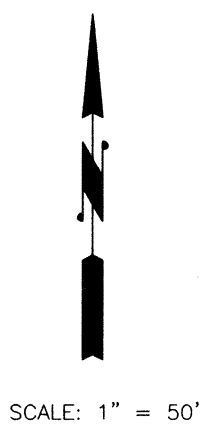

SITE GRADING GENERAL NOTES

ALL VEGETATION MATERIALS AND UNSUITABLE SOIL SHALL BE REMOVED FROM FILL AREAS PRIOR TO PLACEMENT OF FILL.

ALL GRADE AND FILL IS TO BE DONE SO AS TO SATISFY THE REQUIREMENTS PER APPENDIX CHAPTER 33, UNIFORM BUILDING CODE. (EXCAVATION & GRADING)

SUN SYSTEMS, INC. 1004 COMMERCIAL AVENUE, SUITE 152 ANACORTES, WA 98021-4165 (360) 293-1960	SCHEMMER ENGINEERING INC. 1004 COMMERCIAL AVENUE, SUITE 152 ANACORTES, WA 98021-4165 (360) 293-1960
SITE PLAN FOR FABRIC PLACEMENT SEQUENCING PLAN - GRADING	
JOB NO. 98-012	REVISIONS PER CITY REVIEW REVISIONS PER ARCHITECT REVIEW
SHEET C3	DESIGNED: JAS DRAWN: SBK CHECKED: JAS DATE: 5/14/99
3 OF 11	DATE BY APP REVISIONS