

30.00						30.00
25.00						25.00
20.00						20.00
15.00						15.00
10.00						10.00
5.00						5.00
0.00						0.00
-5.00						-5.00
-10.00						-10.00
-1+00	0+00	1+00	2+00	3+00	4+00	5+00

SANITARY SEWER GENERAL NOTES

ALL MATERIALS AND WORKMANSHIP SHALL CONFORM TO CURRENT APWA SPECIFICATIONS WHEN NOT COVERED BY CITY OF ANACORTES STANDARDS AND SPECIFICATIONS.

PVC SEWER PIPE SHALL BE RUBBER GASKET CONFORMING TO APWA STANDARDS.

THE CONNECTION TO THE MANHOLE SHALL BE WITH A SANDCOLLAR GROUTED DIRECTLY IN THE MANHOLE. GROUT FROM BOTH SIDES.

THE CONTRACTOR SHALL CALL UTILITY UNDERGROUND LOCATE (800-424-5555) 48 HOURS PRIOR TO CONSTRUCTION AND NOTIFY THE CITY UTILITIES DEPARTMENT (360-293-1921).

PRESSURE TESTING SHALL BE DONE BY THE CONTRACTOR AT 5 PSI FOR 20 MINUTES WITH NO LOSS OF PRESSURE.

6" SIDE SEWERS SHALL MAINTAIN A 2% MINIMUM GRADE.

ALL APPLICABLE PERMITS SHALL BE OBTAINED PRIOR TO COMMENCING CONSTRUCTION WITHIN THE CITY RIGHT-OF-WAY.

PRE-CONSTRUCTION MEETING BETWEEN CITY AND CONTRACTOR TO BE HELD PRIOR TO THE COMMENCEMENT OF ANY SITE WORK.

ONLY FACTORY BEVELED JOINTS WILL BE ALLOWED IN ALL SEWER MAINS, EXCEPT AT SIDE SEWER LOCATIONS.

SIDE SEWER SHALL BE MARKED AS SHOWN ON DETAIL SHEET.

ALL MANHOLES, CLEANOUTS, RINGS, AND COVERS SHALL BE LOCATED WITHIN THE BLACKTOP.

PROJECT ENGINEER SHALL BE RESPONSIBLE TO COMPLETE AND RESUBMIT TO THE WASHINGTON STATE DEPARTMENT OF ECOLOGY THE DECLARATION OF CONSTRUCTION UPON COMPLETION OF THE PROJECT.

GRAVITY SEWER MAINS SHALL BE PVC, ASTM D 3034 SDR 35, OR ASTM F 789 WITH JOINTS AND RUBBER GASKETS CONFORMING TO ASTM D 3212 AND ASTM F 4777. SIDE SEWER SERVICES SHALL BE PVC, ASTM D 3034 SDR 35

WATER NOTES

NO CONNECTION TO THE EXISTING MAINS WILL BE ALLOWED EXCEPT BY MEANS OF AN APPROVED BACKFLOW PREVENTION DEVICE PRIOR TO SATISFACTORY FLUSHING, TESTING, DISINFECTION, AND RECEIPT OF SATISFACTORY BACTERIOLOGICAL TEST RESULTS.

TAPS ON EXISTING MAINS WILL BE MADE BY SPEARS TAPPING, INC. AT THE DEVELOPER'S EXPENSE.

ALL WORK AND MATERIALS MUST CONFORM TO THE CITY OF ANACORTES STANDARDS.

THE CITY OF ANACORTES ENGINEERING DEPARTMENT CONSTRUCTION MUST BE NOTIFIED AT LEAST 24 HOURS PRIOR TO COMMENCING CONSTRUCTION, AND FOR INSPECTION REQUESTS.

THE OWNER OR OWNER'S AUTHORIZED AGENT SHALL NOTIFY THE MAINTENANCE OR OPERATIONS SUPERVISOR OF A PERSON WHO CAN BE CONTACTED ON A 24 HOUR BASIS.

WATER MAIN SHALL HAVE 30" MINIMUM COVER.

WATER MAINS SHALL CONSIST OF DUCTILE IRON AWWA C 155-76, CEMENT MORTAR LINING AWWA C 104-74 THICKNESS CLASS 50 MINIMUM, OR EQUAL.

WATER AND SEWER HORIZONTAL SEPARATION SHALL BE 10 FOOT MINIMUM. MINIMUM 1 FOOT VERTICAL CLEARANCE BETWEEN WATERLINE AND ALL OTHER UTILITIES.

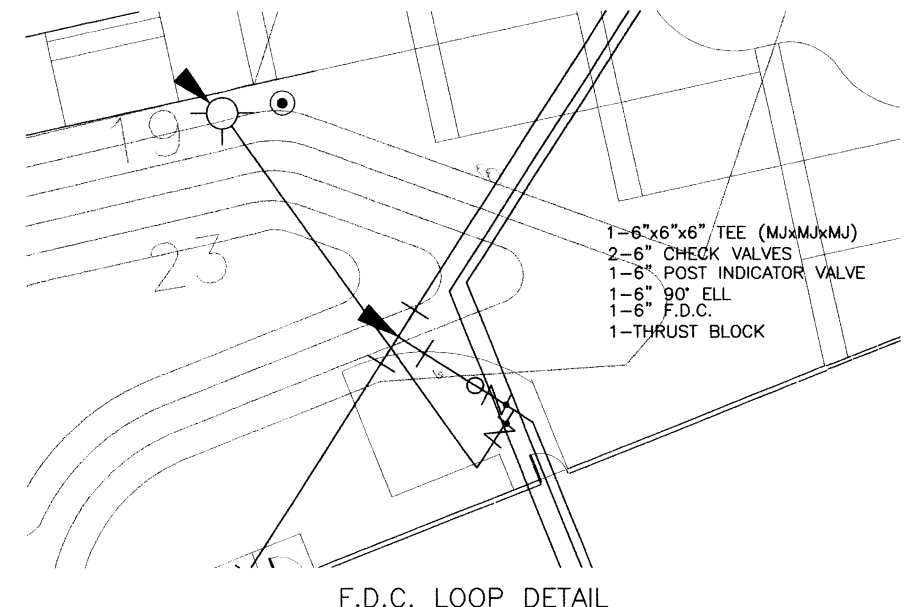

F.D.C. LOOP DETAIL

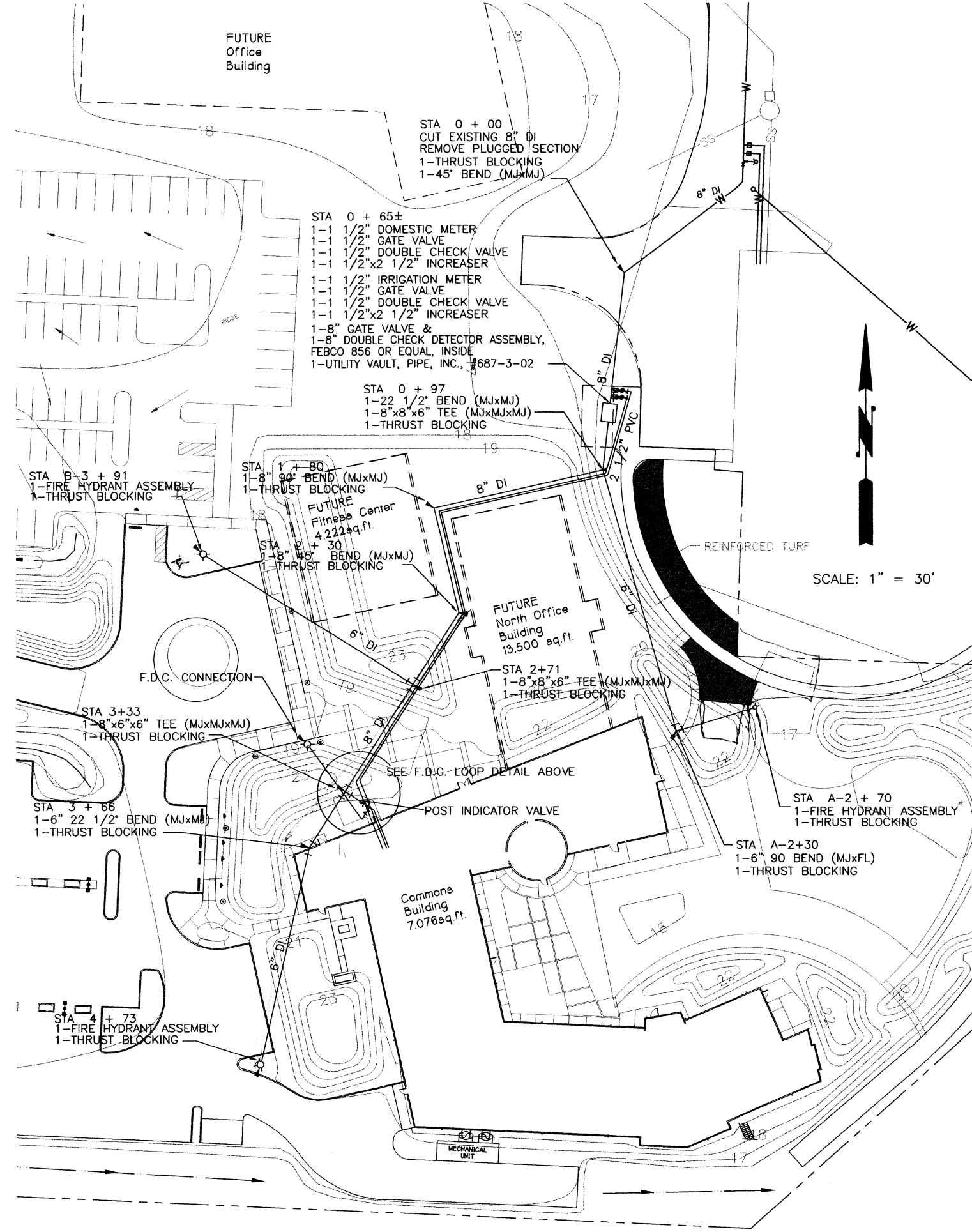

SCALE: 1" = 30'

DESIGNED	JAS	DATE	12/17/99
DRAWN	SK	DATE	12/17/99
CHECKED	JAS	DATE	12/17/99
BY		DATE	12/17/99

REVISIONS:

NO.	DATE	DESCRIPTION
1	12/17/99	REVISED PER CITY REVIEW
2	12/17/99	REVISED PER CITY REVIEW
3	12/17/99	REVISED PER ARCHITECT REVIEW

SUN SYSTEMS, INC.
SANITARY SEWER/WATER

SCHEMMER ENGINEERING INC.
1804 COMMERCIAL AVENUE, SUITE 132
ANACORTES, WA 98221-4163 (360) 293-1960

JOB NO. 98012
SHEET C7
7 OF 11